



# Gregory Gardens

Eastfield, Northampton

oriordanbond  
SALES & LETTINGS





GROUND FLOOR  
578 sq.ft. (53.7 sq.m.) approx.

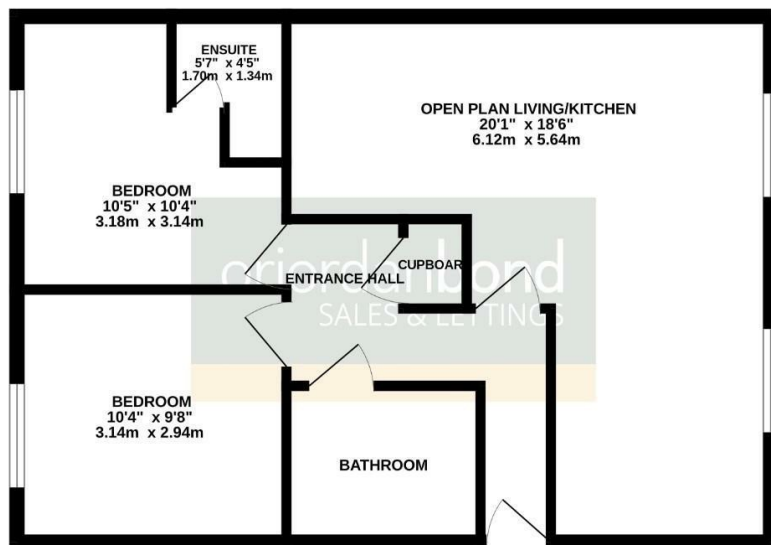

TOTAL FLOOR AREA : 578 sq.ft. (53.7 sq.m.) approx.  
Whilst every attempt has been made to ensure the accuracy of the floorplan contained here, measurements of doors, windows, rooms and any other terms are approximate and no responsibility is taken for any error, omission or mis-statement. This plan is for illustrative purposes only and should be used as such by any prospective purchaser. The services, systems and appliances shown have not been tested and no guarantee as to their operability or efficiency can be given.  
Made with Metrepace ©2026

## Gregory Gardens

Eastfield

NN3 2BF

GUIDE PRICE £150,000

A well presented two bedroom first floor apartment situated within this popular development. The property is offered for sale with no onward chain and would make an ideal first time purchase or buy-to-let investment.

The accommodation comprises communal entry, entrance hall, open plan living area incorporating a fitted kitchen, two double bedrooms with en-suite shower room to master and a three-piece bathroom suite. Outside are communal gardens and an allocated parking space. Further benefits include electric heating and uPVC double glazing. (A/578/-)

Leasehold Information: Lease Remaining - 83 years (as of 2026) / Ground Rent - £300 per annum / Service Charge - £1090 per annum

### Additional information

- Council Tax Band: C
- Energy Efficiency Rating: B

### Viewing

Viewing strictly by appointment – details below

### Disclaimer

O'Riordan Bond Estate Agents Limited has not tested apparatus, equipment, fittings or services and so cannot verify they are in working order. The buyer is advised to obtain verification from their solicitor or surveyor.

O'Riordan Bond Abington East Sales  
01604 639007

abingtoneast@oriordanbond.co.uk

